

# Old Town Village

Of Ellendale Farm

## The Coachhouse 3 Bedroom

Heartland Builders of NWI



ELEVATION A

### Custom Craftsmanship Throughout

- 2188.5 sq ft
- 3 bedroom 2 story
- Full basement
- Front covered porch and a back patio
- Master suite with:
  - Large walk-in closet
  - Tiled Walk in shower
- Dinette area
- Hardwood flooring
- Custom Painted trim package
- 9' ceiling
- 93% efficient furnace
- 2x6 exterior walls
- Blown in blanket insulation system
- Craftsmen style exterior
- Landscape & sprinkler system

Discover our quaint cottage homes  
offering many different floor plans

Contact us at:

219-227-9533

[Heartlandbuild.com](http://Heartlandbuild.com)

[rick@heartlandbuild.com](mailto:rick@heartlandbuild.com)

Builder of Finely

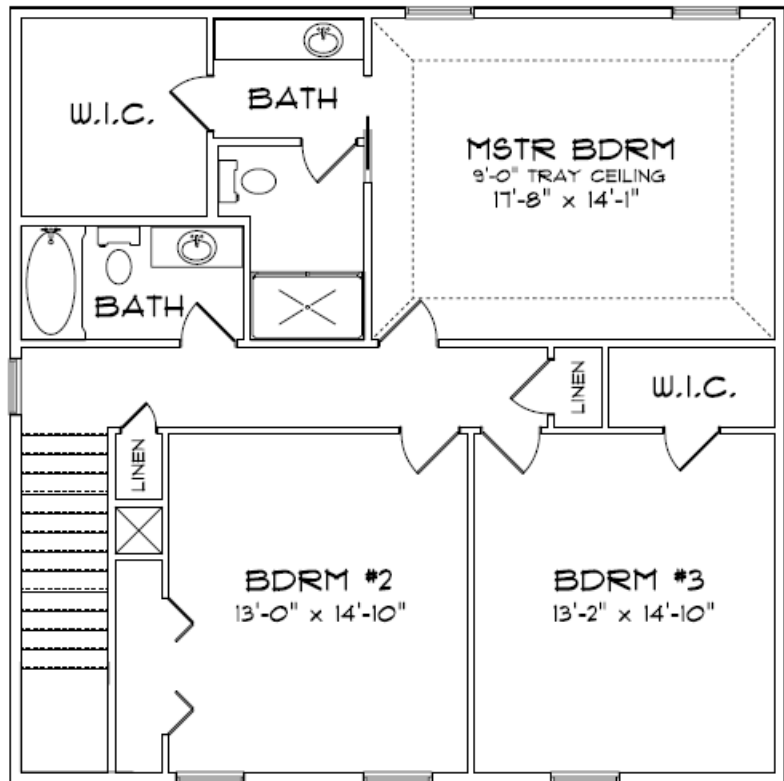
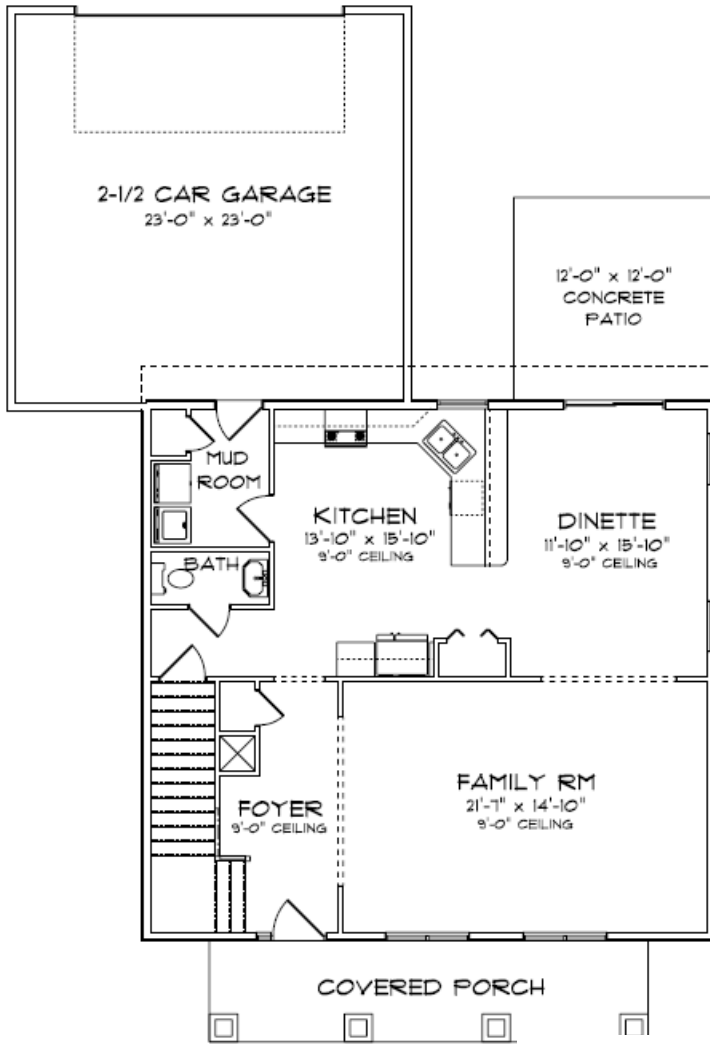

Three Bedroom  
2188.5 Sq. Ft.